



Flat 9 Woodvale Court, Widmore Road, Bromley, Kent, BR1 3AA

£125,000

- First Floor Retirement Studio Flat
- Modern Bathroom
- Gated Resident Parking
- EPC Rating: C
- 51 sqm Spacious Lounge/Diner/Bedroom
- Two Balconies
- Close to High Street & Local Amenities
- Separate Kitchen
- Double Glazed
- No Onward Chain

First Floor

Approx. 63.8 sq. metres (686.5 sq. feet)

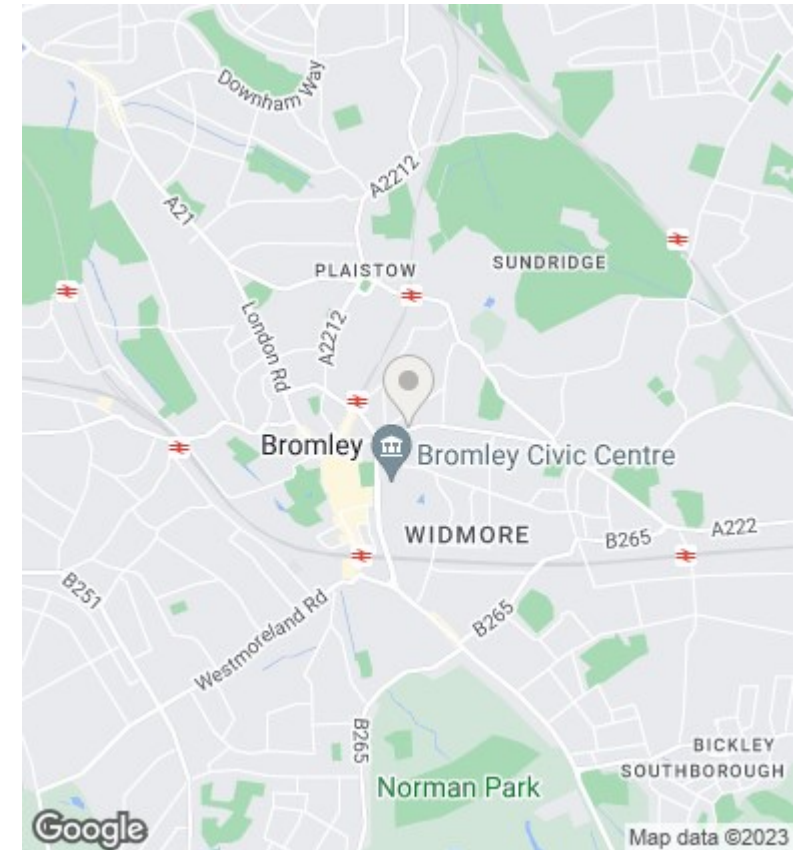
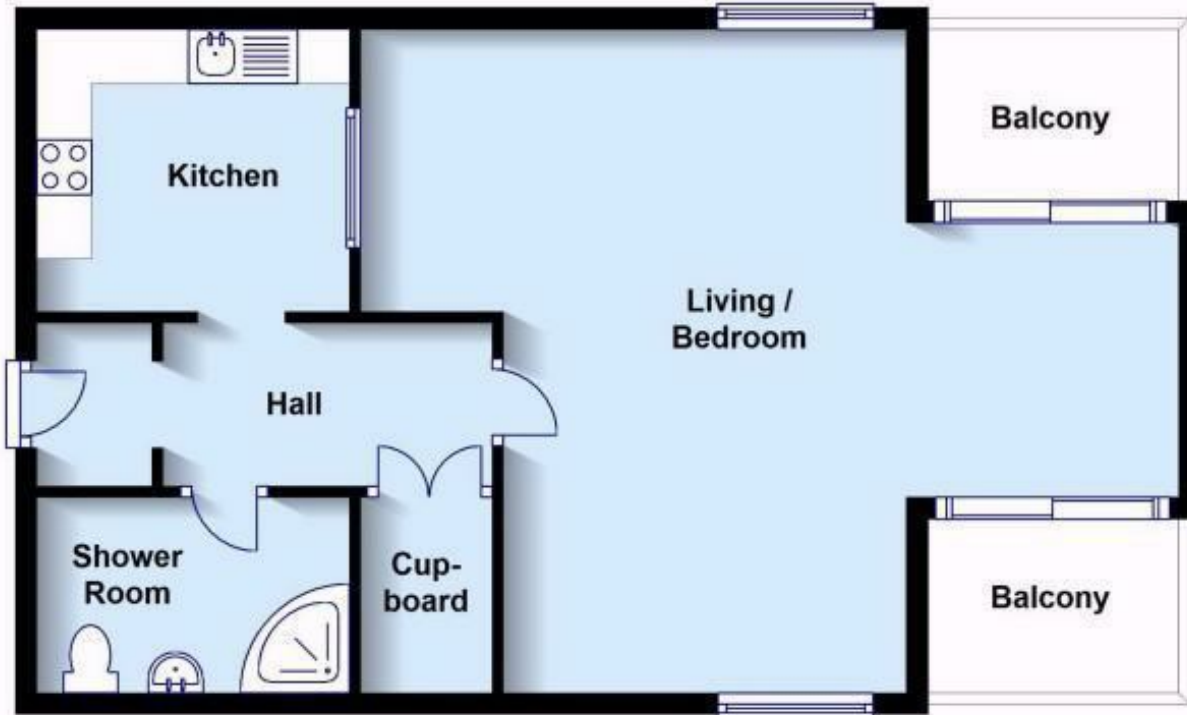

Directions

Viewings

Viewings by arrangement only. Call 020 8663 3322 to make an appointment.

Council Tax Band

B

EPC Rating:

C

Energy Efficiency Rating		Current	Potential
<i>Very energy efficient - lower running costs</i>			
(92 plus) A			
(81-91) B			
(69-80) C		74	82
(55-68) D			
(39-54) E			
(21-38) F			
(1-20) G			
<i>Not energy efficient - higher running costs</i>			
England & Wales		EU Directive 2002/91/EC	